

FLOOR COATINGS





KÖSTER Industrial Flooring System

- *Dust free*
- *Abrasion resistant*
- *Available in different colors*
- *Adjustable slip resistance*
- *Low emissions, tested according to the AgBB*
- *Economical*

Highly resistant floor coating for interior rooms, industry and production

Floors in industry and production facilities are subjected to a multitude of stresses, especially mechanical stresses through forklift traffic, machines, or shocks through falling objects.

Concrete floors subjected to such stresses are covered with the self-leveling industrial floor coating KÖSTER LF-VL.

The substrate must be prepared, dry, clean, and freed of all bond inhibiting substances. It is then primed with KÖSTER LF-BM (when moisture is present in or below the slab with KÖSTER VAP I 2000) and finally coated with KÖSTER LF-VL.

The top layer can also be adjusted for various slip resistance classifications by broadcasting with kiln dried silica sand or various top coats.

Additionally the complete system can be installed with low emission materials according to the AgBB guidelines and can therefore be installed in critical interiors such as schools or hospitals.

Top coat

KÖSTER LF-VL

Slip resistance (optional)

KÖSTER Quarzsand

Floor coating

KÖSTER LF-VL

Primer

KÖSTER LF-BM

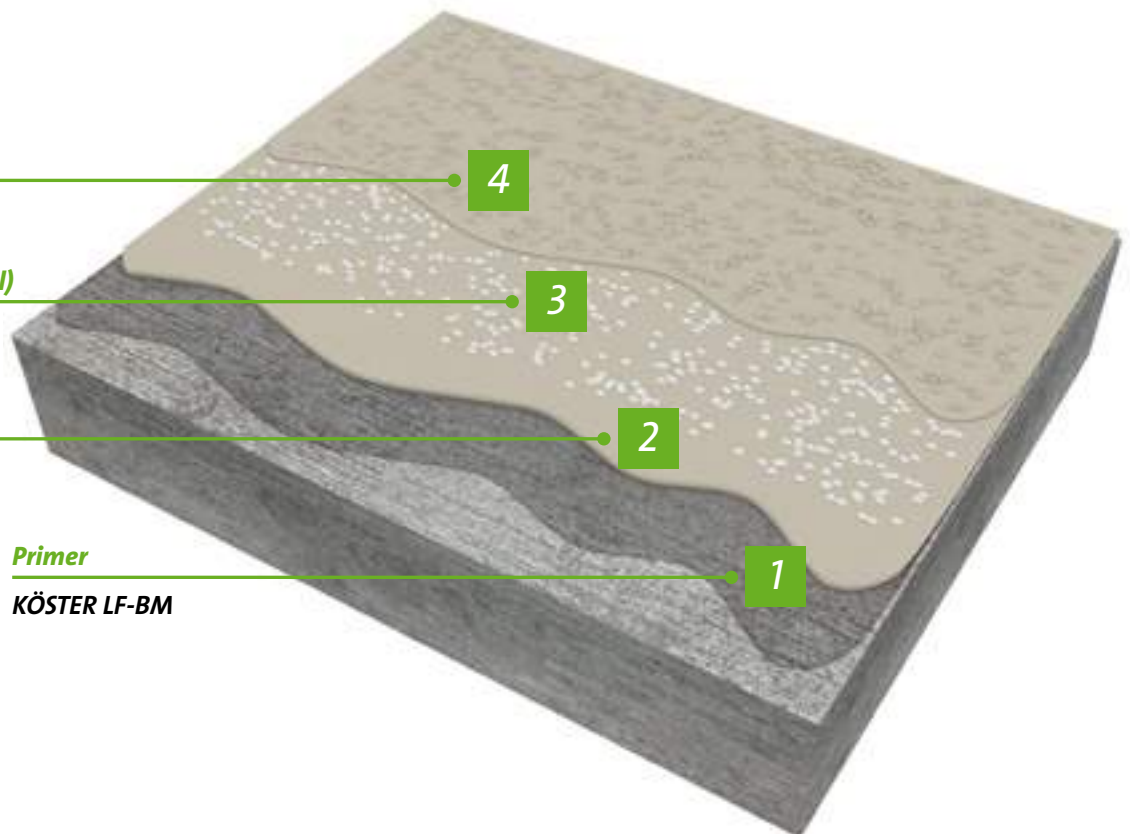



KÖSTER UC-System

- *High chemical resistance*
- *High abrasion resistance*
- *Suitable for moist substrates*
- *Self-leveling*
- *Heat resistant*
- *Early loadable*

Hygienic protective coating for the food production industry

KÖSTER UC combines properties of mineral floor leveling materials (leveling and repair of mineral substrates) and reactive resin coatings (protection against penetrating substances and damage as well as decorative design) in one product. It is based on a polymer binder (polyurethane) and mineral fillers.

KÖSTER UC Systems can therefore be used in a wide variety of fields of application with high demands on the coating such as in the food production industry (production, kitchens) as well as in chemical and pharmaceutical industries. KÖSTER UC can be installed in new construction projects (retail) and in the renovation of production areas which must be quickly open to traffic.



Temperature shock resistant



Chemically resistant



Food safe

Coating and substrate leveling

KÖSTER UC

Substrate

Surface preparation with shotblasting

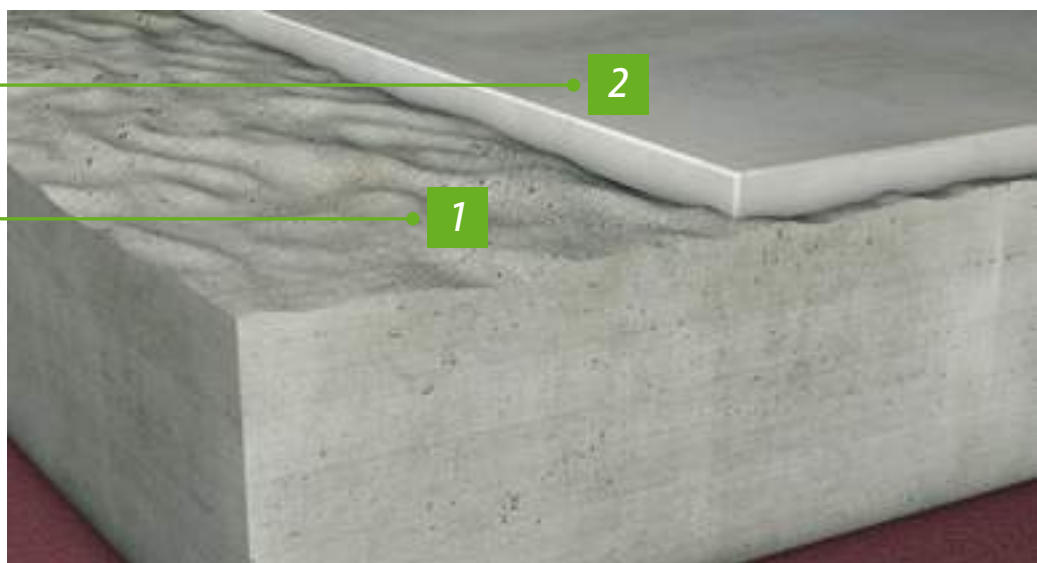



KÖSTER ESD-System

- *Permanently electrically conductive according to the DIN EN 61340-4-1:2016*
- *Meets the highest requirements*
- *Low VOC emissions*
- *Fast and easy installation*
- *Also for use in repair / renovation*
- *Easy cleaning and care*

Static discharge protective coating for shock sensitive production areas

In areas where electronics are manufactured or in areas that can be electrostatically charged by people or machines, the floor must have a sufficiently high electrostatic dissipation to eliminate the risk of damage. For this ESD protection areas are required, (ESD : Electrostatic Discharge) where special ESD coatings are installed.

The KÖSTER ESD System has a structure that provides maximum protection against unwanted electrical charges. The product system consists of the conductive layer KÖSTER ESD 175, which is a solvent free epoxy resin dispersion that is simply applied with a roller. After only two hours it is cured and can be connected to the building grounding.

KÖSTER ESD 275 is applied as the top coat. After cure it not only protects the concrete from chemical and mechanical stresses, it also maintains the high electrostatic dissipation required for an ESD protected area. The KÖSTER ESD System has been tested according to the DIN EN 61340-4 by the KIWA Polymer Institute Ltd. The excellent test results allow the KÖSTER ESD System to be used in rooms with very high requirements.

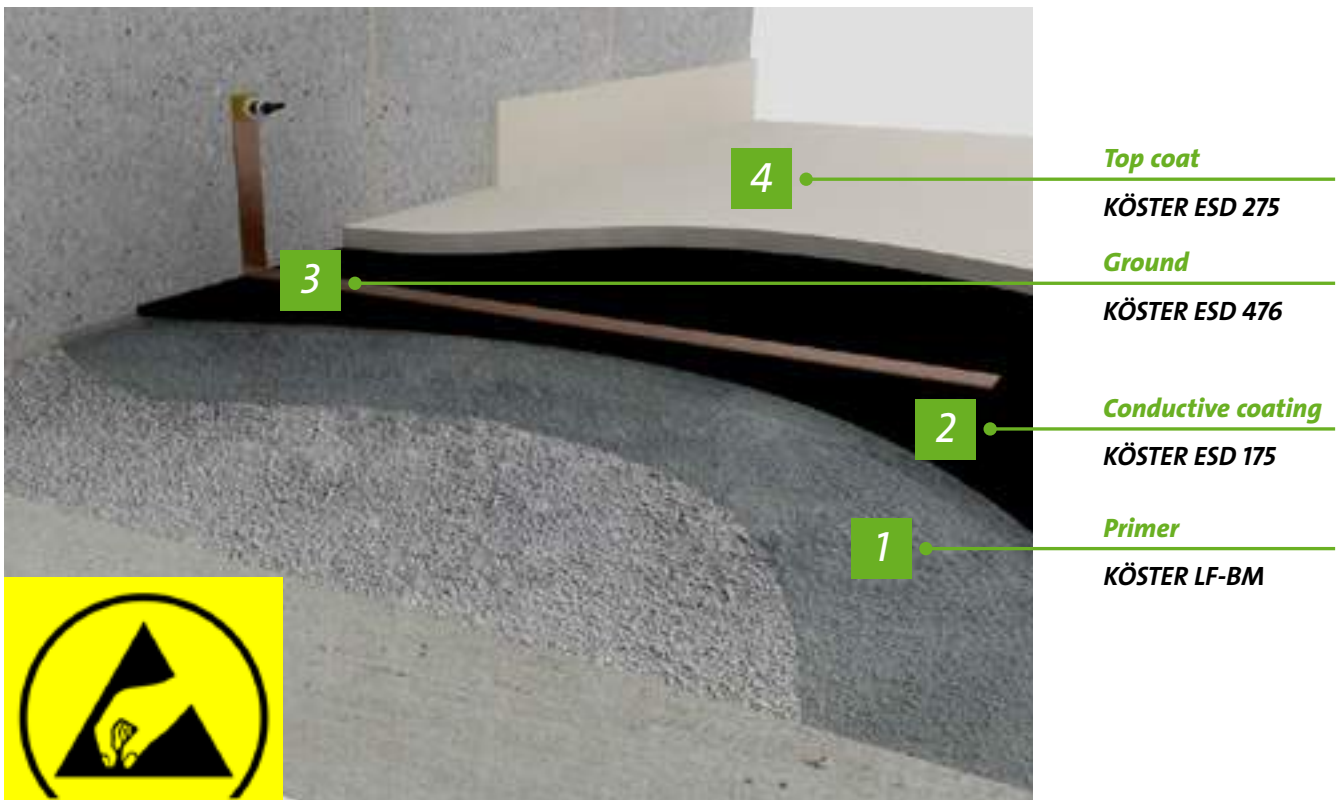



KÖSTER OS 8-System

- *Very high abrasion resistance*
- *Plasticizer and oil resistant*
- *Protection against rear-side moisture*
- *In accordance with DIN EN 1504-2 and DIN V 18026, OS 8*
- *Available in different colors*

Parking garages and trafficked surfaces with high mechanical stresses

Parking garages and trafficked areas have especially high requirements on coatings. The KÖSTER OS 8 System is a highly resistant, easy to apply solution.

Surface preparation is critical. A clean, dry surface free of all bond-inhibiting materials is vitally important. The surface is primed with KÖSTER CT 121, into which KÖSTER CT 482 Silica Sand is broadcast.

Through the broadcast with KÖSTER CT 482 a very

high mechanical resistance is attained, as well as a slip resistance.

The top coat consists of the solvent free KÖSTER CT 221. The Coating System is tested according to the DIN EN 1504-2 and fulfills the supplementary standard DIN V 18026.

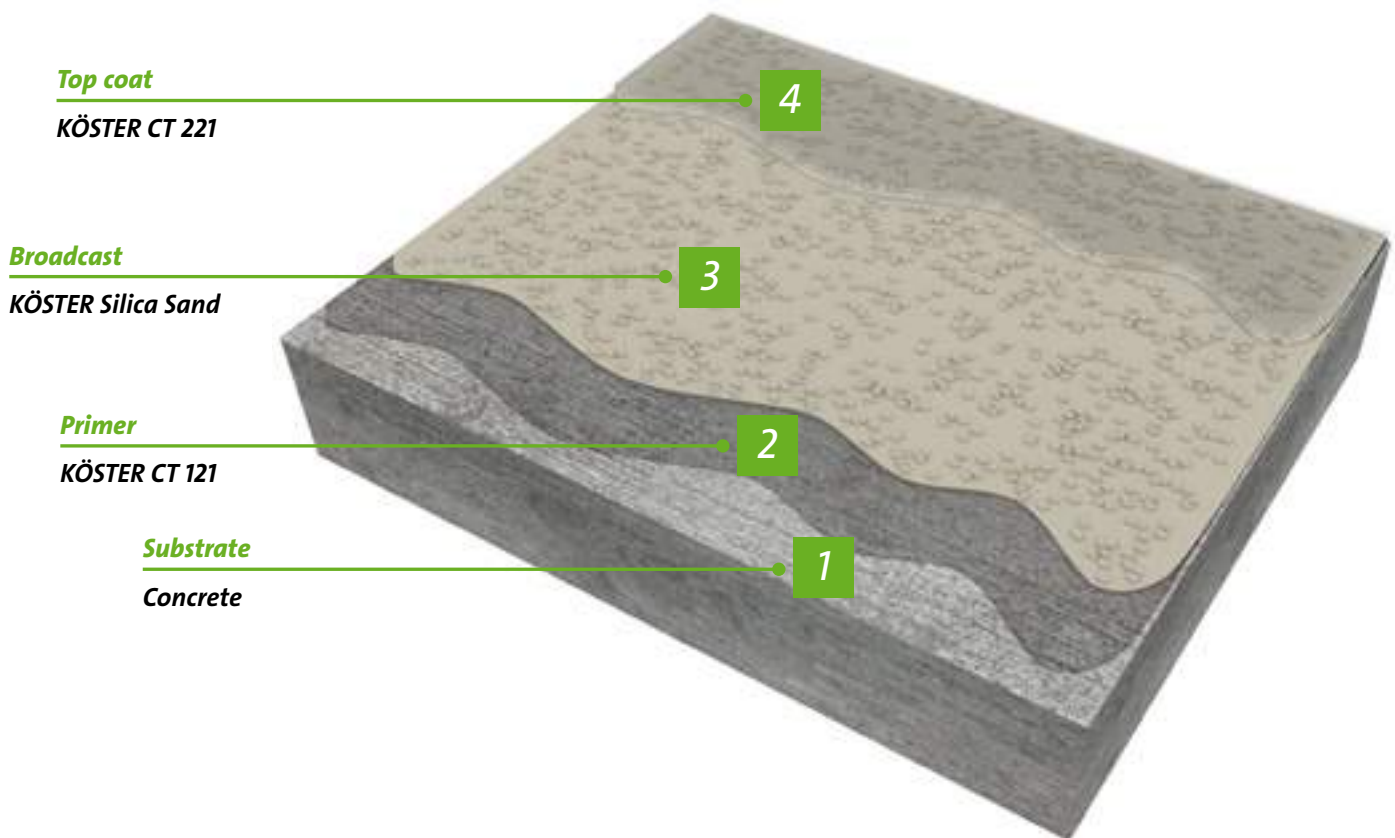



KÖSTER BTG-System

- *Customizable*
- *Abrasion resistant*
- *Weather-resistant*
- *Quick application*
- *Slip resistant*
- *Easy to clean*
- *Non-yellowing*

Decorative showrooms with customizable design

The KÖSTER BTG System is a visually appealing floor coating system for concrete and screed floors. It is comprised of KÖSTER LF-BM (primer), KÖSTER EM-VS (resin coating), KÖSTER Color Chips (color and slip resistance) and KÖSTER TS Transparent (transparent surface sealant). The BTG System protects balconies,

terraces, laboratories, offices, and other commercial areas including living spaces against abrasion, weathering, and chemical stresses.

The system stands out due its slip resistance and its ease of cleaning.



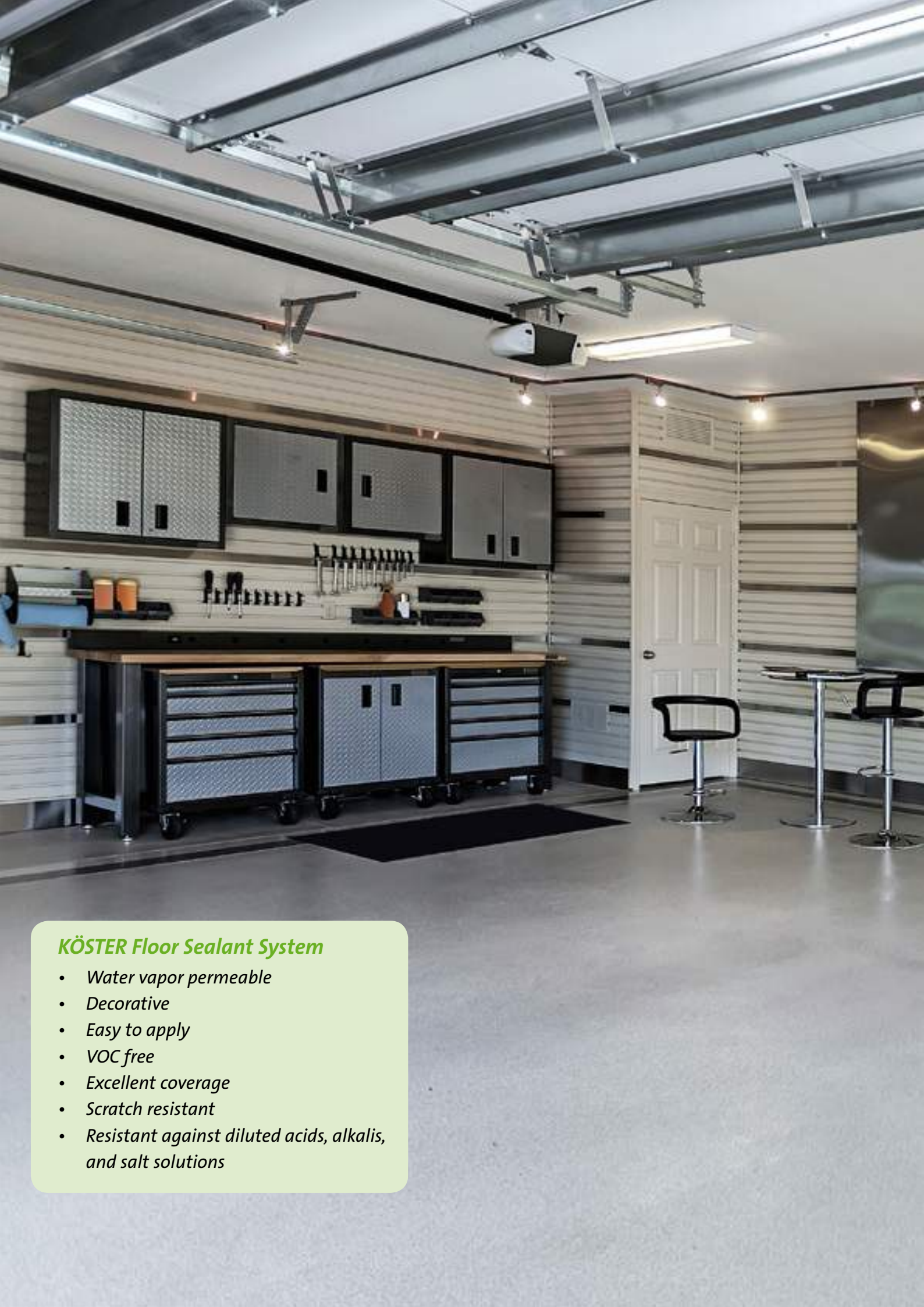

KÖSTER Floor Sealant System

- *Water vapor permeable*
- *Decorative*
- *Easy to apply*
- *VOC free*
- *Excellent coverage*
- *Scratch resistant*
- *Resistant against diluted acids, alkalis, and salt solutions*

Economical and fast protection for basements and utility rooms

Concrete floors exposed to moderate stresses are ideally and easily coated with the decorative floor sealant KÖSTER EM-VS. The coating is rolled in two layers onto the prepared and cleaned concrete

surface. The baseboard skirting can also be installed using KÖSTER EM-VS mixed with KÖSTER Thickening Agent.

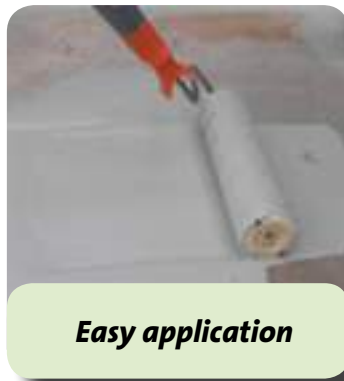

Floor coating

KÖSTER EM-VS

2

Primer

KÖSTER EM-VS

1

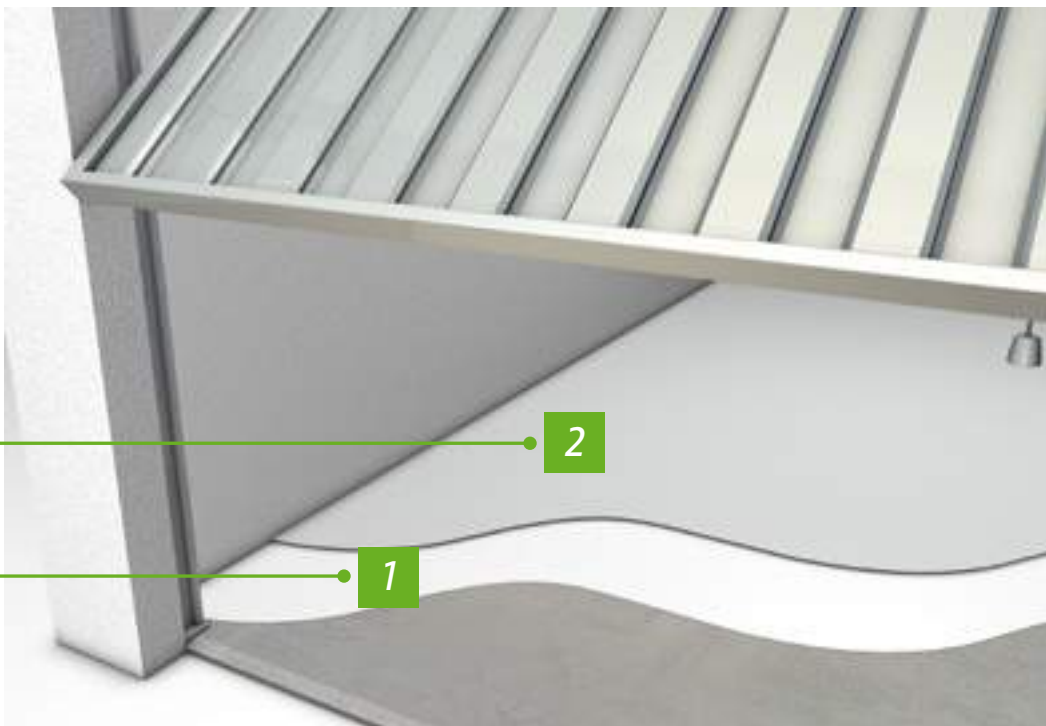



KÖSTER SL Flex

- *Excellent bonding characteristics*
- *Applicable on wood, concrete, tile, steel, mastic asphalt*
- *Can be installed over floor heating*
- *Layer thickness 2-15 mm*
- *Resistant to foot traffic after 3-4 h*
- *Coatable after approx. 48 h*

Flexible, fast hardening, universal self-leveling underlayment for wood, and mastic asphalt, and floor heating

KÖSTER SL Flex is a high quality, fast setting, mineral based underlayment with excellent bonding characteristics also to smooth and dense substrates. KÖSTER SL Flex is applicable on a wide variety of substrates and hardens hydraulically and tension free within a few hours.

It hardens to a level, high strength surface that allows for a change in building use, such as carpet or tiles on top of old wooden floors.



Wooden substrates



Floor heating



Very flexible

Self-leveling underlayment

KÖSTER SL Flex

3

Primer

KÖSTER VAP I 06

2

Substrate

Wood

1

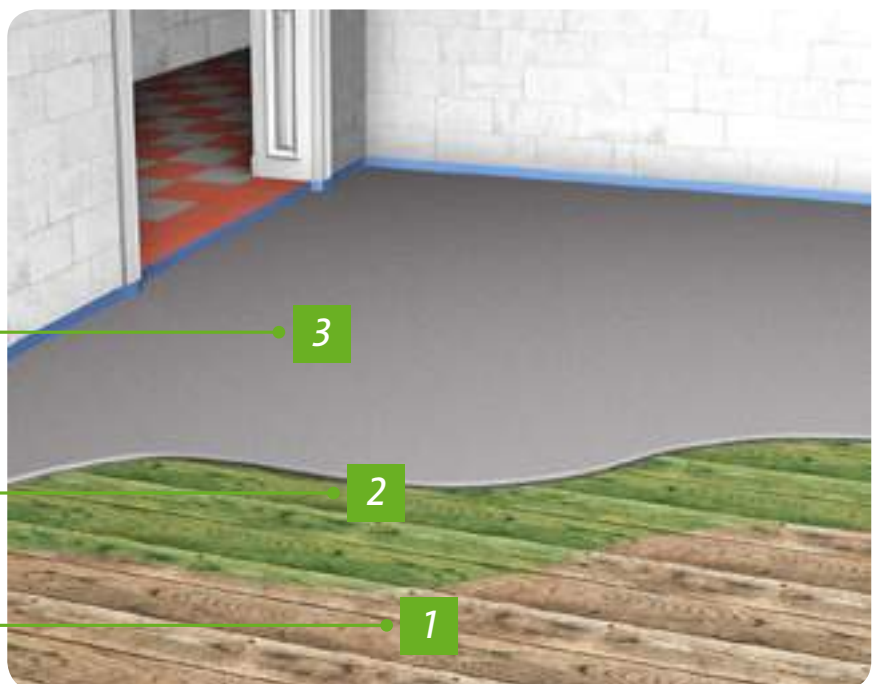



Service you can depend on

With our service and distribution network in many countries world-wide we can offer you professional advice and technical support immediately and on the spot. Your required waterproofing materials can be delivered promptly and will protect your property efficiently and lastingly.

For further information, please contact:



*KÖSTER BAUCHEMIE AG | Dieselstraße 1–10 | D-26607 Aurich | Germany
Phone: +49 (4941) 9709-0 | Fax: +49 (4941) 9709-40 | info@koster.eu | www.koster.eu*